

> HK417

CAL. 7.62 MM X 51 NATO



FLEXIBILITY THAT HITS THE SPOT.

MODULAR, RELIABLE AND WITH HIGH PENETRATING POWER: THE HK417 IS THE HK416'S "BIGGER BROTHER". ITS 7.62 MM X 51 NATO CALIBRE MEETS ALL THE REQUIREMENTS EXPECTED OF A MODERN, LARGE-CALIBRE ASSAULT RIFLE.



H E C K L E R & K O C H G E R M A N Y

HECKLER & KOCH-STR. 1 / 78727 OBERNDORF A.N., GERMANY / PHONE: +49 (0)742379-0 / FAX: +49 (0)742379-2350
SALES@HECKLER-KOCH-DE.COM

H E C K L E R & K O C H U S A

19980 HIGHLAND VISTA DRIVE, SUITE #190 / ASHBURN, VA 20147, USA / PHONE: +1 (0)703450-1900 / FAX: +1 (0)703450-8160
INFO@HECKLER-KOCH-US.COM

H E C K L E R & K O C H U K

P. O. BOX 7151 / NOTTINGHAM NG7 2TD, GREAT BRITAIN / PHONE: +44 (0)11592487-20 / FAX: +44 (0)11592487-30
ENQUIRIES@HECKLER-KOCH-UK.COM

H E C K L E R & K O C H F R A N C E

7, RUE DE LA PLAINE / 78860 SAINT-NOM-LA-BRETÈCHE, FRANCE / PHONE: +33 (0)1610623-00 / FAX: +33 (0)1610623-09
INFO@HECKLER-KOCH-FR.COM

WWW.HECKLER-KOCH.COM

OUR TRADITION MEANS CONSISTENCY.

THE STORY OF HECKLER & KOCH STARTED IN 1949. THE DEVELOPMENT OF THE G3 AND THE INTRODUCTION OF THIS MILESTONE AS THE INFANTRY RIFLE FOR THE GERMAN ARMY IN 1956 WERE THE FIRST STEPS ON THE ROAD TO BECOMING A WEAPONS MANUFACTURER OF EXCELLENCE. EVEN THEN OUR STRATEGY, WHICH HAS NOT CHANGED OVER THE YEARS, WAS: NO COMPROMISE.

To be consistent means to accept no compromise throughout our product range. For us, this means using only premium materials, utilising only the most advanced manufacturing processes, and striving continuously towards innovation. The safety of the user and excellence in after sales support are central to this philosophy.

This is why our small arms products are the first choice for the military and the police forces of many NATO countries and their allies.

The Heckler & Koch “Weapons Range” philosophy optimises logistics and economics that result in minimum long term cost and maintenance of the product for the customer. Our refusal to compromise in manufacturing and design ensures the maximum durability of the weapon and results in financial benefits in the long term.

The care and commitment we put into the manufacture of our products is at the centre of our relationship with our customers, employees and the environment. In this way, we create the basis of our own future as an innovative company.

CONTINUED SUCCESS.

AS THE HK416'S "BIGGER BROTHER", THE HK417 CARRIES THE BATON OF GLOBAL SUCCESS, BRINGING THIS TRIED AND TESTED RELIABILITY TO ANOTHER CALIBRE RANGE. WITH THE HK417, HECKLER & KOCH HAS IMPLEMENTED NUMEROUS TECHNICAL CHANGES ARISING DIRECTLY FROM ITS DAILY USE.

An infantry weapon was required with a fighting range over 500 metres and an effective terminal ballistic performance. There was increased popular demand from users for an easy to use and easily maintained assault weapon with optional silencer.

Our designers have fully satisfied these demands with the HK417. Its 7.62 mm x 51 NATO calibre not only provides the necessary range and penetrating power — but the handling is designed to be similar to the HK416 or comparable assault rifles. The HK417 is the first assault rifle in the world built to provide a full silencer option — a result of the unique gas regulation patented by Heckler & Koch that allows the user to switch from normal to silencer mode on the spot.

Thanks to the continued rigorous application of the modular concept, the HK417 provides an excellent level of flexibility and modularity. This produces one hundred percent interchangeability of the weapon system's components. The maximum numbers of components possible are compatible with the HK416, regardless of calibre. Various barrel lengths are available depending on their intended use, which means that the HK417 can be deployed in almost any scenario.

At the same time, the free-floating rail system, patented by Heckler & Koch (MIL-STD-1913), gives the rifleman the freedom to choose the range of special accessories that he needs. In contrast to the traditional steel magazine, Heckler & Koch opted for a lighter and highly resistant polymer magazine for the HK417.

The use of add-on devices with assault rifles is becoming ever more important. With its improved GLM add-on grenade launcher, Heckler & Koch offers a universal support weapon that can be used with the HK417 and the HK416. With the suitable adapters, the GLM can be mounted on numerous third-party products. The GLM can be deployed as a stand-alone weapon in combination with a variety of buttstocks.

With the HK417, Heckler & Koch has created a weapon system for difficult operations under the most unfavourable conditions, and once again has set unique standards on a global scale.

THE PERFECT BARREL FOR EVERY SCENARIO.

HECKLER & KOCH BARRELS ARE AMONGST THE MOST ROBUST AND DURABLE IN THE WORLD. IN ORDER THAT THE USER DOES NOT RUN OUT OF OPTIONS IN ALL SORTS OF OPERATIONS, THE HK417 IS AN EASY TO USE AND FLEXIBLE SYSTEM THAT CAN BE FITTED WITH A CHOICE OF THREE BARREL LENGTHS — 12", 16" AND 20". THE CHANGEOVER IS SIMPLE AS ONLY THE BARREL ASSEMBLY GROUP HAS TO BE CHANGED.





HK417 – 12"

The compact version: ideal for use in close quarters combat, with rapid and precise firing and effective on moving targets. Good handling characteristics for use in enclosed spaces such as houses, underground or sewer systems where vision and manoeuvrability are restricted.



HK417 – 16"

The multi-purpose version for use in open terrain. Ideal for high rate of fire in close-range combat or accurate, penetrating single shots in long-range combat.



HK417 – 20"

The long-range version. Designed for use as a semi-automatic designated marksman rifle by troops and for securing operational areas. Effective and accurate at fighting ranges of 400–800 m.

INDIVIDUALITY COMES FROM INNOVATION.

THE HK417 IS A WEAPON SYSTEM THAT GUARANTEES THE USER THE PERFECT MIXTURE OF INDIVIDUAL OPTIONS AND ABSOLUTELY RELIABLE AND FUNCTIONAL TECHNOLOGY. THE CENTRAL ELEMENT OF THIS MODULAR PRINCIPLE IS THE UPPER RECEIVER ASSEMBLY WITH ITS FREE-FLOATING PICATINNY HANDGUARD (MIL-STD-1913). THIS CAN BE USED TO ATTACH AN ADD-ON GRENADE LAUNCHER, OPTICAL SIGHTS, TACTICAL LIGHTS, AND MUCH MORE.

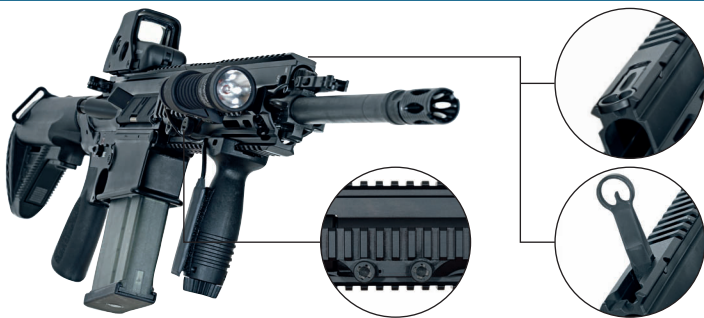

360° INDIVIDUALITY

The free-floating handguard system patented by Heckler & Koch (MIL-STD-1913) allows the shooter to mount accessories exactly where he needs them. A special feature: Sights that have already been adjusted do not have to be zeroed again after the handguard is removed and re-installed. Practical: The handguard can be released using the carrying sling hook or the bolt head, among other things. Optional: The front sight folds down into handguard.



FLEXIBILITY AND COMFORT

The extendable buttstock can be locked in various positions, thus allowing adjustment of the length of pull and eye relief as desired. The protected release lever prevents unintentional release and snagging, as well as protecting against injuries and fouling. The buttstock contains the rear attachment eyes for the carrying sling. Inside the buttstock are compartments for batteries and tools. A choice of convex or concave-shaped shoulder rests is available.

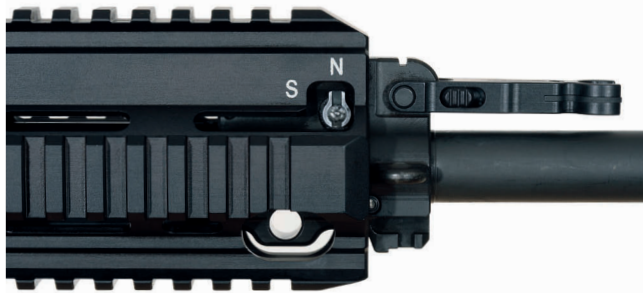

FUNCTIONAL INTEGRATION

The gas block simultaneously combines multiple functions: It houses the folding front sight, the front eyes for attaching the carrying sling, mounting points for a bayonet and the GLM add-on grenade launcher, and the optional gas regulation for use with a silencer.

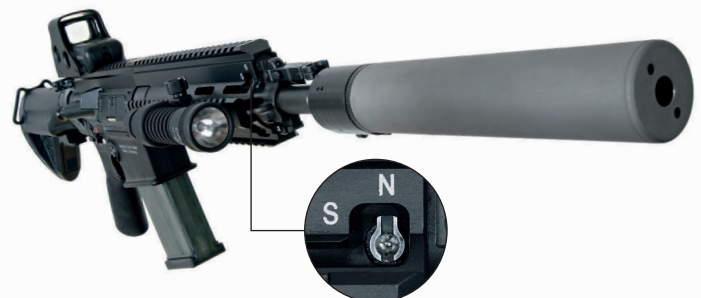

SILENCERS – SIMPLE AND FAST

Highly innovative and unique: The gas regulation patented by Heckler & Koch. Unlike with most rifles, when a silencer is used on the HK417 the gas regulation does not have to be adjusted by the manufacturer. With the optional gas adjustment on the HK417's gas block, the user can make the adjustment himself, quickly and easily.

THE ASSAULT RIFLE THAT CAN DO IT ALL. AND THAT NEVER LETS YOU DOWN.

THE HK416 HAS ALREADY PROVED ITSELF IN MANY OPERATIONAL USES: IT IS NOT ONLY ABSOLUTELY RELIABLE BUT ALSO MORE VERSATILE THAN ALMOST ANY OTHER ASSAULT RIFLE. THE SAME IS TRUE FOR THE HK417: IT FUNCTIONS PERFECTLY IN EXACTLY THE SAME WAY AS ITS SMALLER COUNTERPART IN ALL CLIMATIC CONDITIONS AND ASSOCIATED DEGREES OF DIRT, AND IS, AT THE SAME TIME, EASY TO USE AND CONVERT.



ALWAYS THE RIGHT COMBINATION

The HK417's standard trigger can optionally be replaced with a two-stage trigger ("match trigger"). A let-off point before the trigger actually releases allows the shooter to remain calmer and more confident. Similarly to the selection of different grips, the fire selector lever can be located as desired (only on the right, only on the left, only on both sides). The HK417: ideal combination options for every shooter.



OVER THE BEACH TEST: PASSED

The HK417 is designed so that it is ready to fire immediately after being submerged underwater – in extreme situations it can also be shot from the water without endangering the rifleman himself. Indispensable for combat operations on coastlines, lakes and rivers.



LOTS OF DIRT, NO MALFUNCTIONS

In the HK 417, the receiver, magazine and action are designed and built in such a way that the weapon will not malfunction even when heavily fouled, e.g. with sand or mud. In its gas system, the piston and driving rods permit hardly any fouling deposits. Dirt particles and gases are no longer blown into the upper receiver, thus preventing malfunctions. The optimised lead-in chamfer of the magazine well makes changing magazines much faster and easier than with other rifles – especially in the dark.



EVEN GREATER SUPERIORITY

The GLM add-on grenade launcher can be used to achieve a tremendous increase in the user's firepower. The GLM does not affect the handling of the weapon (e.g. when changing magazines); the trigger can easily be controlled using the index finger. The GLM can shoot a wide range of different munitions for a broad spectrum of applications, including non-lethal weapons.

EXPONENTIAL SUPERIORITY.

COMBINATION WITH AN ADD-ON GRENADE LAUNCHER TRANSFORMS THE HK417 INTO A SYSTEM WITH SUPERIOR FIREPOWER. LIKE THE HK417, THE GLM HAS BEEN DEVELOPED USING THE MODULAR PRINCIPLE. THESE CONFIGURATION OPTIONS OFFER THE USER A LARGE NUMBER OF VARIANTS: WHETHER AS THE RIFLE ALONE (SAM = STAND ALONE MODULE), OR WITH THE GRENADE LAUNCHER: THE INDIVIDUAL ADVANTAGES OF THE DIFFERENT VARIANTS CAN BE PUT TO USE TO OPTIMALLY SUIT ON PLANNED MISSION. ANOTHER ADVANTAGE: THE ADD-ON GRENADE LAUNCHER IS 100% COMPATIBLE WITH THE HK416.



GLM – A POWERFUL COMBINATION

The GLM is an add-on launcher for 40 mm x 46 grenades of any length. It can be attached to the handguard of the HK417 without the use of tools. The barrel swivels out to the left to allow changing of the cartridge. In contrast to other solutions available on the market, a barrel that swivels only to one side leaves only minimal axial tolerances between the cartridge and the chamber. Using a separately available adapter, the GLM can be adapted to a wide variety of assault rifles, for example types M4/M16.



SAM GLM – A SOLUTION INDEPENDENT OF THE SYSTEM

The GLM's modular design makes it possible to transform the GLM basic model into an independent grenade launcher, the SAM GLM (Stand Alone Module). This is done simply by combining the basic model with optionally available HK accessories.

EVERYTHING THAT A PERFECT WEAPON SYSTEM NEEDS.

ANY NUMBER OF ACCESSORIES ARE AVAILABLE TO FURTHER ENHANCE THE HK417 – A PERFECT WEAPON SYSTEM. ONE ADVANTAGE IN TERMS OF LOGISTICS AND COST-EFFECTIVENESS IS THE FACT THAT, BESIDES THE ACCESSORIES DEVELOPED BY US, IT IS ALSO NO PROBLEM TO CONTINUE USING EXISTING ACCESSORIES.

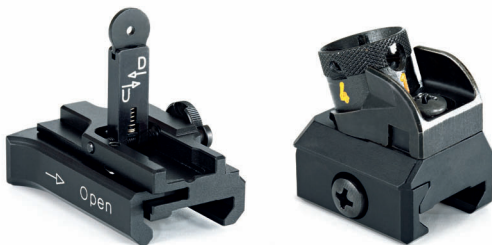

IRON SIGHTS

For maximum accuracy and a consistent point of impact.



HARRIS BIPOD WITH PATENTED HK ADAPTER

For a secure rest: The bipod allows good aiming even on uneven ground. Quick installation is possible using the Heckler & Koch patented bipod adapter.



HK417 POLYMER MAGAZINE

Light and extremely robust. Available with magazine capacity of 10 or 20 rounds.



GRIP VARIANTS

Keeping a grip on any situation: Versions available with storage compartment for mechanical sights.



THE CHARGING HANDLE

Can be used on either side. Can be extended on the left, right or both sides.



CONVEX OR CONCAVE RECOIL PAD

To hold the weapon to the shoulder securely.

TECHNICAL DATA

	HK417 – 12“	HK417 – 16“	HK417 – 20“
Calibre	7.62 mm x 51 NATO		
Operating principle	Gas-operated		
Bolt system	Rotating bolt		
Feed mechanism	Magazine, 10/20 rounds		
Cartridge case ejection	Right		
Modes of fire	Single fire/Sustained fire		
DIMENSIONS			
A Length, max.	884 mm	985 mm	1087 mm
A Length, min.	804 mm	905 mm	1007 mm
B Width	82 mm	82 mm	82 mm
C Height ¹	213 mm	213 mm	213 mm
D Barrel length ²	305 mm	406 mm	508 mm
E Sight radius	410 mm	410 mm	473 mm
WEIGHT			
Weapon without magazine ¹	approx. 4250 g	approx. 4450 g	approx. 4800 g
Magazine, 20 rounds (empty)	approx. 160 g	approx. 160 g	approx. 160 g
Magazine, 20 rounds (fully charged) ³	approx. 680 g	approx. 680 g	approx. 680 g

OTHER DATA

Trigger pull	34 N	34 N	34 N
Rate of fire	approx. 600 rounds/min	approx. 600 rounds/min	approx. 600 rounds/min
Muzzle velocity -v0- ³	approx. 735 m/s	approx. 786 m/s	approx. 815 m/s
Muzzle energy -E0- ³	approx. 2550 J	approx. 2920 J	approx. 3138 J
Barrel profile/twist	Groove/land profile, 4 grooves, right-hand twist 280 mm		
Sight ⁴	Mechanical dioptré sight		

NOTES

Rails for accessories: MIL-STD-1913 (Picatinny) on handguard at 3, 6, 9, 12 o'clock and on top of receiver. Adjustable buttstock: 80 mm adjustment travel, 5 positions.
Optional: trigger with 25 N trigger pull, concave/convex buttstock plate.

¹ Without sight, front sight folded down / ² Without flash hider / ³ Ammunition DM111 / ⁴ Different sights can be mounted

Subject to modification

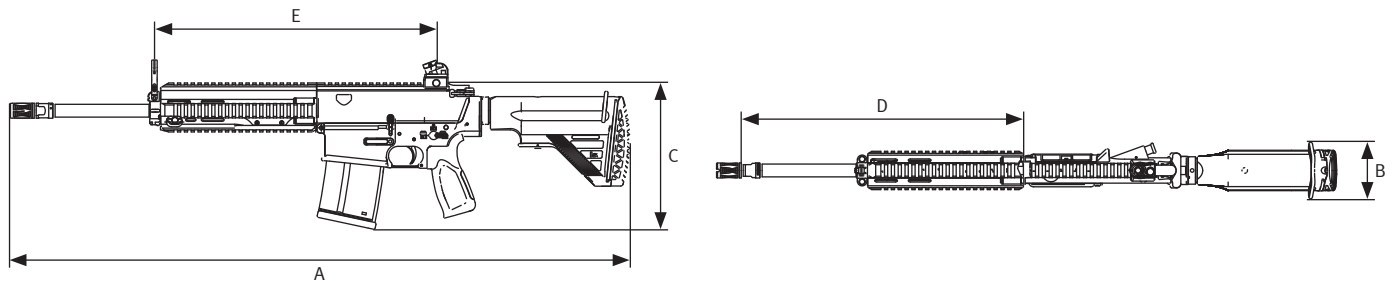

TECHNICAL DATA

	GLM HK416/417	GLM SAM
Calibre	40 mm	
Operating principle	Single loader	
Bolt system	Breech-loading, break-action barrel	
Feed mechanism	Manual	
Cartridge case ejection	Manual	
Modes of fire	Single fire	
DIMENSIONS		
A Length, max.	285 mm	518 mm
B Length, min.	–	434 mm
C Width	75 mm	99 mm
D Height, max.	161 mm	331 mm
E Height, min.	–	210 mm
F Barrel length	229 mm	229 mm
G Sight radius	148 mm	148 mm
WEIGHT		
Weapon ¹	approx. 1270 g	
Ladder sight	approx. 130 g	
Buttstock	approx. 800 g	
Forward grip with rail	approx. 100 g	
Adapter HK416, HK417/M4/M16	approx. 80 g/approx.175 g/approx. 235 g	

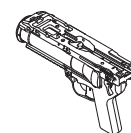

GLM BASIC WEAPON

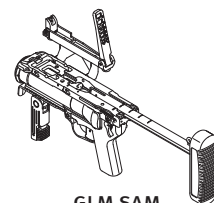

GLM SAM

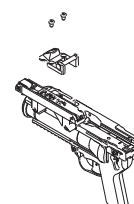

GLM HK416/417

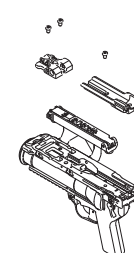

GLM M4

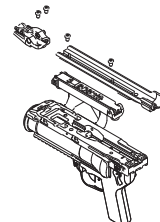

GLM M16

OTHER DATA

Trigger pull	60 ± 10 N	60 ± 10 N
Muzzle velocity -v5 ⁻³	approx. 75 m/s	approx. 75 m/s
Barrel profile/twist	Groove/land profile, 6 grooves, right-hand twist 1200 mm	
Sight ⁴	Mechanical ladder sight, sight steps increasing by 50 m	

NOTES

Fires 40 mm x 46 ammunition of any length. Adjustable buttstock: 81 mm adjustment travel, 4 positions. Optional: MIL-STD-1913 (Picatinny) on the side for accessories. Ladder sight with Tritium inlays available.

¹ Basic weapon

Subject to modification

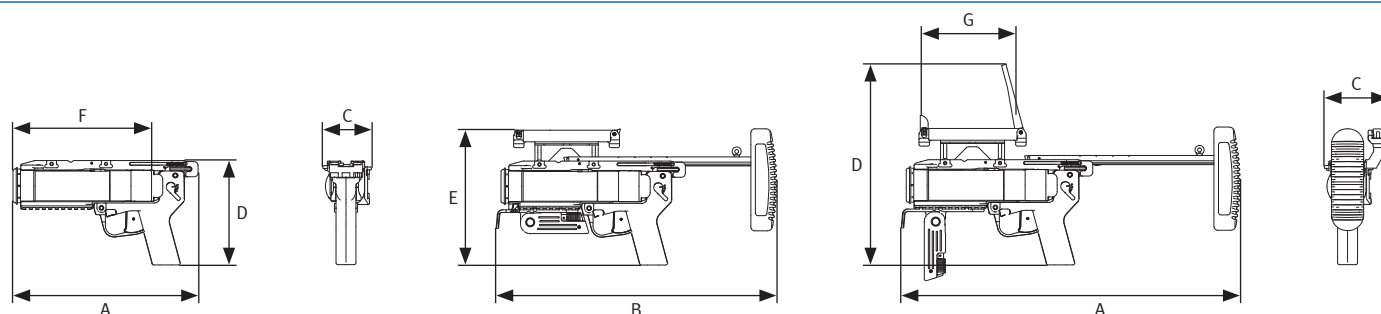

FLASH HIDER

FREE FLOATING MIL-STD-1913 (PICATINNY)
RAIL SYSTEM
To adopt accessories

UPPER RECEIVER

MECHANICAL DIOPTRIC SIGHT

INTERFACE FOR CARRYING SLING

BOLT CATCH
RELEASE

CENTRALLY ARRANGED CHARGING HANDLE
Ambidextrous

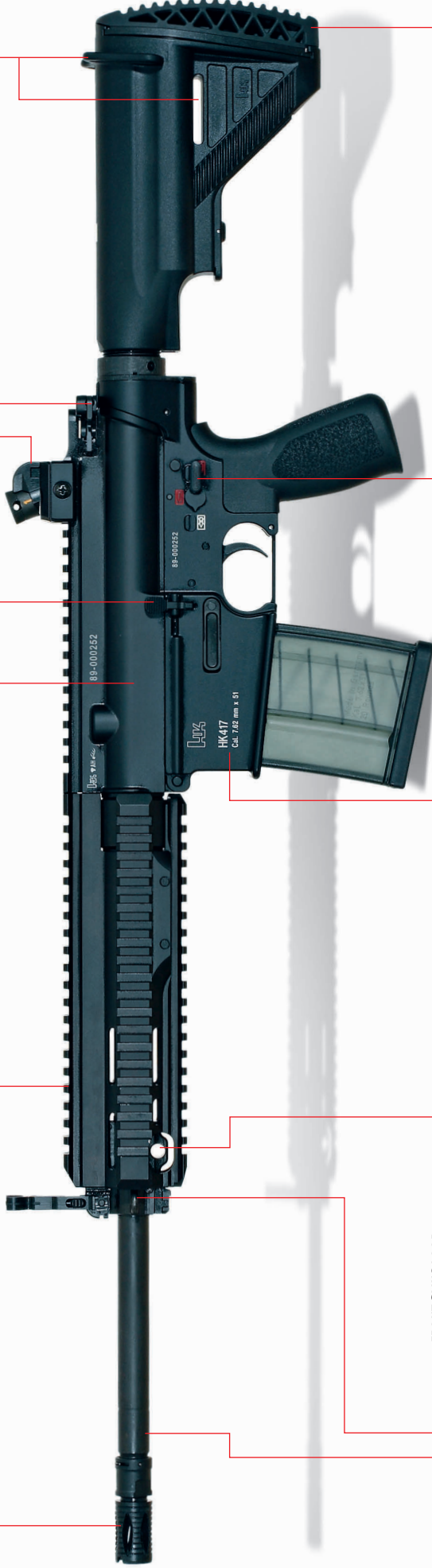

FRONT SLING LOOP
For carrying sling

HARD CHROME-PLATED BARREL
For increased durability

GLM INTERFACE

LOWER RECEIVER

SAFETY LEVER
Left-only, right-only or ambidextrous

RECOIL PAD
Convex or concave

BUTTSTOCK

Lockable in different positions, with integrated storage compartments

**BUTTSTOCK
RELEASE LEVER**

**FORWARD
ASSIST**

CARTRIDGE CASE DEFLECTOR

EJECTION PORT
With dustcover

**ADJUSTABLE GAS PORT
FOR FIRING WITH SUPPRESSOR**
S = Suppressor, N = Normal

FOLDABLE FRONT SIGHT

LOCKING SCREW
To attach the handguard

**MAGAZINE
CATCH**

INTERCHANGEABLE ERGONOMIC PISTOL GRIP
With or without integral compartments

**STANDARD TRIGGER OR
TWO-STAGE MATCH TRIGGER**

POLYMER MAGAZINE
Lightweight and extremely resistant

BAYONET INTERFACE

MULTIFUNCTION GAS BLOCK

